



# THE MARK

## Floor 1

- 2 BR | 2 BA
- 3 BR | 1 BA
- 3 BR | 2 BA
- 3 BR | 3 BA
- 4 BR | 2 BA
- 4 BR | 3 BA
- 5 BR | 3 BA
- 5 BR | 4 BA
- 5 BR | 5 BA





# THE MARK

## Floor 2

- 2 BR | 2 BA
- 3 BR | 1 BA
- 3 BR | 2 BA
- 3 BR | 3 BA
- 4 BR | 2 BA
- 4 BR | 3 BA
- 5 BR | 3 BA
- 5 BR | 4 BA
- 5 BR | 5 BA

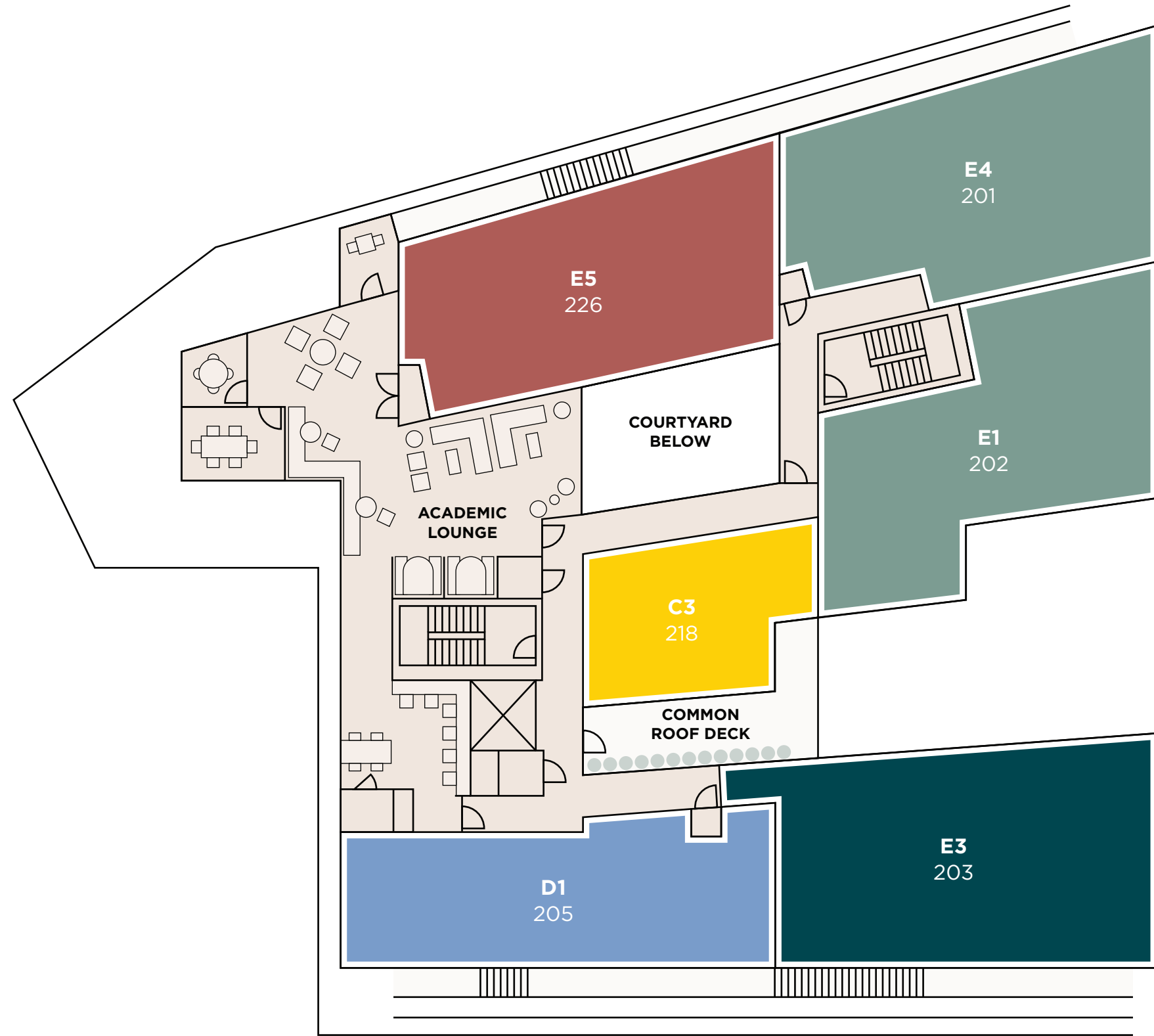

STRATHMORE DRIVE  
& GAYLEY AVENUE  
INTERSECTION ↑

STRATHMORE DRIVE



# THE MARK

## Floor 3

- 2 BR | 2 BA
- 3 BR | 1 BA
- 3 BR | 2 BA
- 3 BR | 3 BA
- 4 BR | 2 BA
- 4 BR | 3 BA
- 5 BR | 3 BA
- 5 BR | 4 BA
- 5 BR | 5 BA

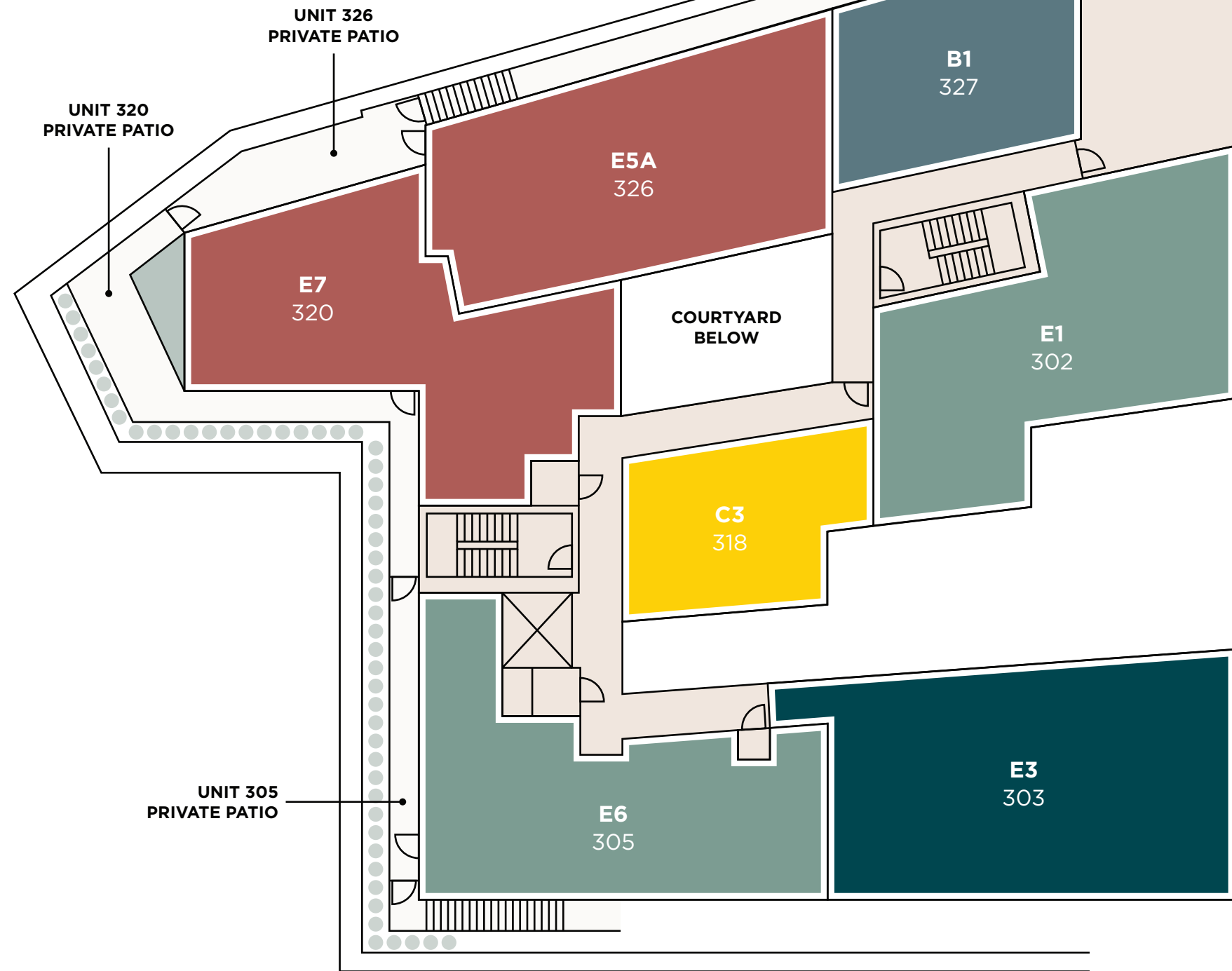

STRATHMORE DRIVE & GAYLEY AVENUE INTERSECTION ↑

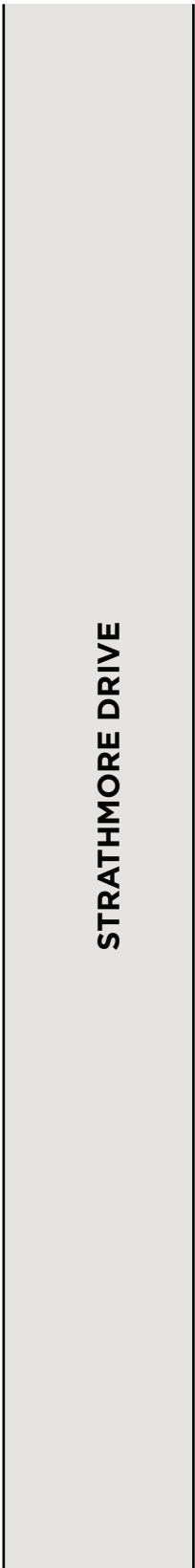



# THE MARK

## Floor 4

- 2 BR | 2 BA
- 3 BR | 1 BA
- 3 BR | 2 BA
- 3 BR | 3 BA
- 4 BR | 2 BA
- 4 BR | 3 BA
- 5 BR | 3 BA
- 5 BR | 4 BA
- 5 BR | 5 BA

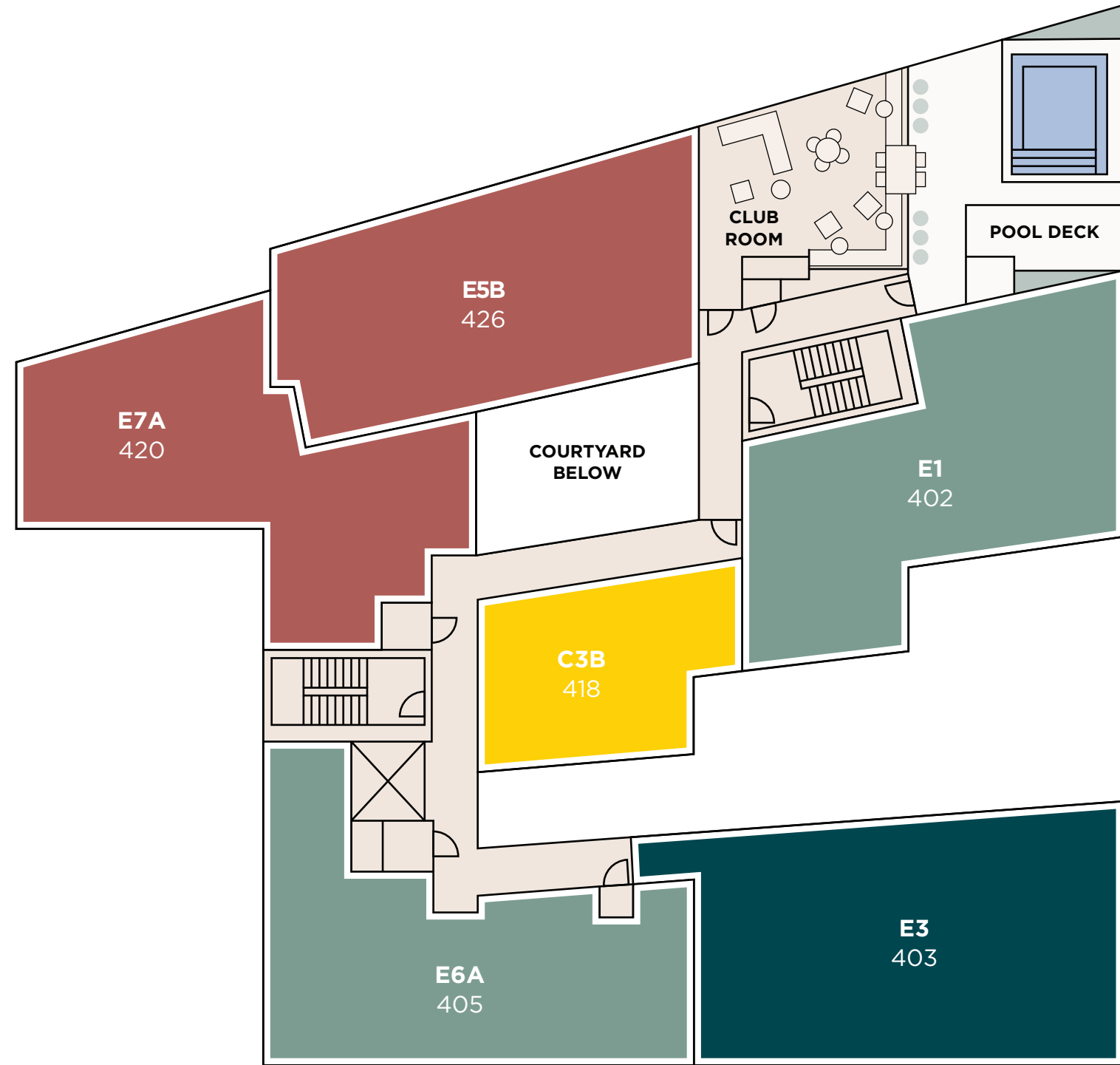

STRATHMORE DRIVE  
& GAYLEY AVENUE  
INTERSECTION ↑

STRATHMORE DRIVE



# THE MARK

## Floor 5

- 2 BR | 2 BA
- 3 BR | 1 BA
- 3 BR | 2 BA
- 3 BR | 3 BA
- 4 BR | 2 BA
- 4 BR | 3 BA
- 5 BR | 3 BA
- 5 BR | 4 BA
- 5 BR | 5 BA

STRATHMORE DRIVE  
& GAYLEY AVENUE  
INTERSECTION ↑



STRATHMORE DRIVE



# THE MARK

## Floor 6

- 2 BR | 2 BA
- 3 BR | 1 BA
- 3 BR | 2 BA
- 3 BR | 3 BA
- 4 BR | 2 BA
- 4 BR | 3 BA
- 5 BR | 3 BA
- 5 BR | 4 BA
- 5 BR | 5 BA

STRATHMORE DRIVE  
& GAYLEY AVENUE  
INTERSECTION ↑



STRATHMORE DRIVE



# THE MARK

## Floor 7

- 2 BR | 2 BA
- 3 BR | 1 BA
- 3 BR | 2 BA
- 3 BR | 3 BA
- 4 BR | 2 BA
- 4 BR | 3 BA
- 5 BR | 3 BA
- 5 BR | 4 BA
- 5 BR | 5 BA



STRATHMORE DRIVE  
& GAYLEY AVENUE  
INTERSECTION ↑

STRATHMORE DRIVE